

N^o 729

(8613)

June 21st 1852 ✓

235

In pursuance of previous notice
legally given to adjoining lands holders
Surveyed John Inskeps lands part of
Robt. Powers original Survey N^o 3680
Beginning at The Southern corner between
Stokes heirs and Wm Stamicks lands, a stone
under the corner of a fence then a pole
thence N 72 $\frac{1}{2}$ E 54.4 poles to a stone thence
S 37 $\frac{1}{2}$ E 209.6 poles to a stone, thence S 57 $\frac{1}{2}$ W
91.2 poles to a stone, thence N 37 $\frac{1}{2}$ W 220.5
poles to a stone South side of Road, thence
N 57 $\frac{1}{2}$ E 40.1 poles to the place of begin-
ning, containing A 124.82

All the corner stones except the begin-
ning on weir planted on said day of
Survey, and under each some pieces of
buck in back

Shos See far
J. E. Bishop } 66
O. J. Govey } 66

East M^o Gaughlin
Surveyor
1852

N^o 730 (8614) July 19th 1852 ✓

I James B M^o Gaughlin Surveyor of Geauga
County in the State of Ohio do. Certify
that under the provisions of the Statute of the State
of Ohio, entitled "an act to enable holders of land
within this State to perpetuate testimony relative to
their lands" and in pursuance of the following
Notice I proceeded to make a resurvey
of Duncan M^o Arthurs Original Survey
N^o 4953 on the waters of Darbys Creek

in the said County of Logan in the manner and guided by the testimony set forth in the following papers, to-wit,

June 21st 1852

Walker Marshall, John Cole, Hudson Haynes, John Hunter, or his agent John Wilson Edmond Moor, Robert Clark agent of John Elbert, Martha Alexander & heirs of Isaac Sharp, Joseph Reed, William Alexander, Elizabeth Curt and heirs of Charles Curt deceased and Arthur Denison you are hereby notified that Jas B M^c Gayles Surveyor of Logan County Ohio has been employed to establish the lines and corners of Duncan McArthur's Original Survey being Military Survey No 4953 together with such corners of subdivisions as shall fall in the said outside lines of said Survey which will be begun on Friday the 16th day of July 1852 between the rising and the setting of the Sun

Atest

R M Reader

Signed

John Vail

Joseph ^{his} D. Daver
mark

Edward Filmore

Jos Inskeep

Thos. Sagan

State of Ohio }
Logan County } SS

Personally appeared Reuben M Reader before me Jas B M^c Gayles County Surveyor of said County and after being sworn to testify the truth the whole truth and nothing but the truth, said: "more than twenty days ago I served the above notice on the persons therein named

by reading the same to them or leaving
written copies at their places of residence"

(Said) Ruben M. Radley,
Sworn to and subscribed
before me this 16th day of
July 1852 Jas B M Laughlin
Surveyor of Co V

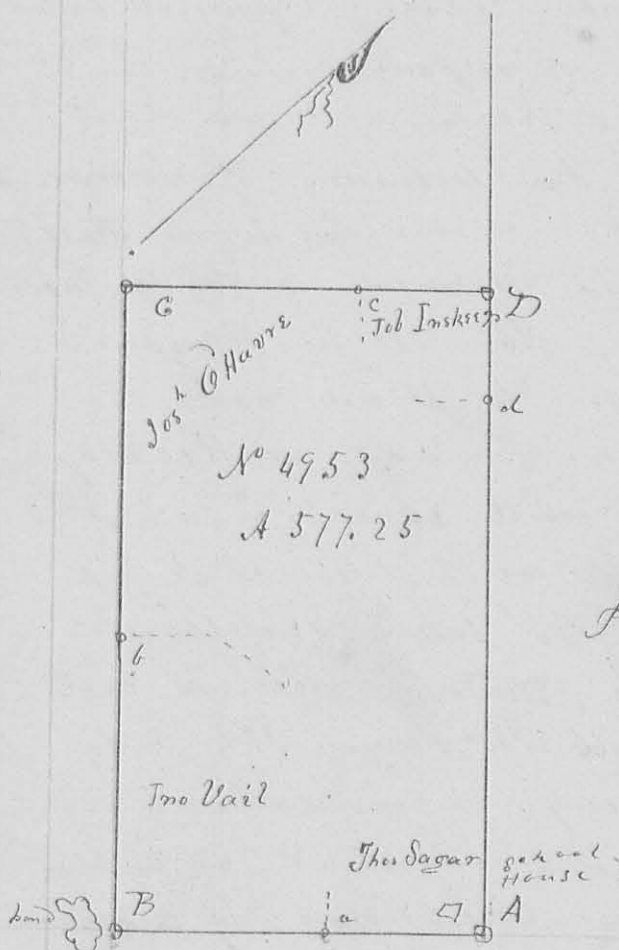

Part of Survey made

In pursuance of the foregoing Notice, on the
16th & 17th days of July 1852,
Beginning at the south west corner of Robert
Powers Original Survey No 3680: at the crossing
of County Roads near a school House (see
point A on the annexed plat,) here the testimony
of John Bishop and do Lot M Smith, was taken
(See depositions thereto annexed) in consideration
of said testimony and in consideration of
the fact that said Roads bear off in
the proper courses, I planted a large Stone

at the point indicated by said witnesses with brick bats underneath, from which the South East corner of said School House bears $N 82^{\circ} W 7 \frac{3}{4}$ poles.

Thence run $S 53^{\circ} W$ (original call being $S 52^{\circ} W$) 232 poles, being 15 poles more than the original call, to a point on the East edge of a pond marked B on the plat, where I found a White Oak stump, and a Sugar stump and a marked line running Northward in the proper course, here the testimony of Immish & Sharp was taken (see depositions hereto attached) in consideration of said testimony and the facts above stated I caused a stone to be planted between said stumps in the road near the edge of said pond, from which a Hickory marked as a line tree, and which I caused to be remarked near the root, stands $N 37 \frac{1}{2}^{\circ} W$ 68 links, on this line as thus established I caused a stone to be planted between the lands of Dr John Bail and The Sugar, 104 poles from the East end thereof, from which an Elm 20 inches diameter bears $N 24^{\circ} E 63$ links, this corner was established by a marked line striking said first run line at this point (see a on plat).

I then ran the second line called for in said McArthur's said survey, beginning at point B on Plat near the Pond, thence $N 37 \frac{1}{2}^{\circ} W$ 396,8 poles (original call being $N 38^{\circ} W 370$) making a difference in distance of 26,8 additional poles and $\frac{1}{2}^{\circ}$ of Eastern variation of course, to a Beech stump marked as a corner and a Hickory down and partially rotten, and a marked line and fence running the proper course

Eastwards, here at The point marked
 C on The Plot, I caused a large stone
 to be planted between said stumps,
 On This line so established I fixed the
 corner between the lands of said Dr John
 Vail and Joseph O'Hare at the point
 K on The plot 1627 poles from the
 Beginning of said line by causing a
 large stone to be planted near a large Ash
 marked as a corner,

I Then ran the Third line called for
 in Said Original Survey N 52 ³/₄ E 234 poles
 to a stone therefore planted near a Sugar tree
 one of the Original Corner trees, distinctly
 marked, Original Call being N 52 E 217 poles
 making an additional distance of 17
 poles, with ³/₄ Eastern variation of course,
 in This line so established and 140.6 poles
 from the Beginning thereof I fixed the
 corner between the lands said O'Hare and
 Job Inskeep (see c on Plot) correspondingly
 to a post corresponding to be pointed out by
 parties concerned, by causing a large
 stone to be planted,

I Then ran the last line called for in
 said Original Survey from said stone
 and Sugar tree marked D on The Plot
 S 37 ¹/₂ E 396 poles to the place of Beginning
 Original Call being S 38 E 370 poles, making
 an additional distance of 26 poles, and
¹/₂ of Eastern variation of course,
 The said Survey so established containing
 Three hundred and Seventy Seven and
 a quarter acres making Seventy Seven
 & a quarter acres more than called for
 by Original Survey,

All the Stones placed as aforesaid were
 placed in presence of Thomas Sagar, Dr John Vail,
 Joseph O'Hare, Job M Smith, Reuben M Rader
 and others

to the correct ness of said Survey
 Plat, and notes I do hereby certify

Las M^cLaughlin
 Surveyor 1860

State of Ohio }
 Logan County } ss

Personally appeared before
 me Las M^cLaughlin County Surveyor of said
 County John Bishop, Job M. Smith and
 Jeremiah E Sharp, while making a survey
 under the Statute for the perpetuation of
 testimony, being first sworn to testify
 the truth the whole truth and nothing
 but the truth touching the existence
 and location of the corners of Duncan
 McArthur's Original Survey No 4953
 deposed and said,

John Bishop } About twelve or thirteen years
 Testimony } ago while I was Supervisor of the
 Roads, I ordered the corner trees
 at the South west corner of Robert

Powers Original Survey to be cut down,
 They were Sugar trees marked as corner
 trees they stood here, and here (points out
 the places)

(Signed) John Bishop

Job M Smith
Testimony

I saw The Stumps of The trees
That Mr Bishop had cut down
at The South West corner of R Powers's
Original Survey They stood here and
here (points out the places)

(Signed) Job M Smith

Jesse E Shanks
Testimony

Some Seventeen or Eighteen
years ago I was ~~here~~
here at The south west corner
of Duncan McArthur's Original
Survey No 4953 at The Edge of
This pond and Camp Road
Superior had a Sugar tree
and a Beech tree marked as
corner trees cut down, There is
The stump of The Sugar and The
Oak, The Beech stump is gone, but
it stood here (points out the place)

(Signed) J E Shanks

Sworn to and subscribed
before me this 16th day of July 1852

Das B M Laughlin
Surveyor G Co O

I do hereby certify that The persons making
the foregoing depositions were of lawful age
and that said testimony was by me re-
duced to writing and by them signed
as therein set forth

In testimony of which I have hereunto
set my hand this 16th day of July 1852

Das B M Laughlin
Surveyor G Co O