

Lee Surveying and Mapping Co., Inc.

Land Surveys • Topography • Subdivisions • Construction Layout

117 N. Madriver St.
Bellefontaine OH 43311



Phone: (937) 593-7335
Fax: (937) 593-7444

DOLL 0.137 ACRE

Lying in Virginia Military Surveys 9925, 9946 and 10121, Washington Township, Logan County, Ohio.

Being all of the Carol J. Doll 0.13 acre tract and 0.036 acre tract as deeded and described in Official Record 288, Page 940, Tracts I and II of the Logan County Records of Deeds and being more particularly described as follows:

Commencing on a 5/8 inch iron rod found at the northwest corner of Lot 209 of Moundwood Allotment (Plat Cabinet A, Slide 231) on the south right-of-way of Edgewater Avenue (40 feet wide).

THENCE, with the west line of Moundwood Allotment, S 7°-10'-19"E, a distance of 718.21 feet to a 5/8 inch iron rod found at the TRUE POINT OF BEGINNING, passing a 7/8 inch iron pipe found at 695.31 feet.

THENCE, with the west line of Moundwood Allotment and said line extended, S 7°-10'-19"E, a distance of 105.20 feet to a MAG nail set on a wood boat dock, passing a 5/8 inch iron rod set at 91.80 feet.

THENCE, N 72°-45'-44"W, a distance of 94.54 feet to a point.

THENCE, with the east line extended and the east line of the Harold M. Hamilton 0.11 acre tract (O.R. 63, Pg. 440, Tract One), N 30°-16'-00"E, a distance of 102.15 feet to a 7/8 inch iron pipe found, passing a 5/8 inch iron rod set at 7.00 feet.

THENCE, with a southerly line of the Kathleen J. Hadley, Trustee, 1.845 acre tract (O.R. 834, Pg. 515, Parcel I), S 65°-11'-47"E, a distance of 28.28 feet to the point of beginning.

Containing 0.137 acre.

The basis for bearings is the west line of Moundwood Allotment, being S 7°-10'-19"E, and all other bearings are from angles and distances measured in a field survey by Lee Surveying and Mapping Co., Inc. on January 10, 2008.



ORIGINAL STAMP IN GREEN

Description prepared by:

William K. Bruce

William K. Bruce
Professional Surveyor 7437
January 11, 2008

4572018

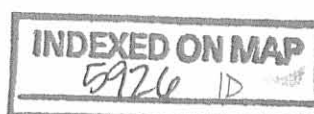

REC'D 1-15-08 SUM 8K

EDGEWATER AVENUE (40')

LOT 209

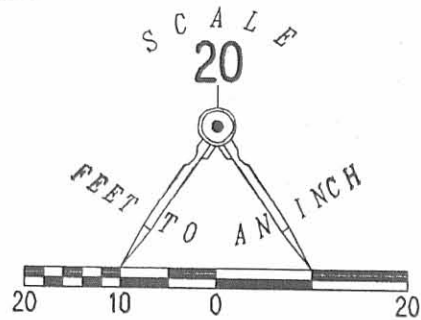

LEGEND:

- 5/8 INCH IRON ROD FOUND
- ⊙ 7/8 INCH IRON PIPE FOUND
- 5/8 INCH IRON ROD SET
- ⊙ MAG NAIL SET

LOT 225

KATHLEEN J. HADLEY, TRUSTEE
1.845 ACRES
O.R. 834, PG. 515
PARCEL 1

LOT 226

HAROLD M. HAMILTON
0.11 ACRE
O.R. 63, PG. 440
TRACT ONE

LOT 227

0.137 ACRE

CAROL J. DOLL
0.13 ACRE AND
0.036 ACRE
O.R. 288, PG. 940
TRACT I & II
(0.101 ACRE)

MOUNDWOOD ALLOTMENT
PLAT CABINET A, SLIDE 231

LOT 228

INDIAN LAKE

RETRACEMENT SURVEY OF THE
CAROL J. DOLL
0.13 ACRE TRACT AND
0.036 ACRE TRACT
OFFICIAL RECORD 288, PAGE 940
TRACT I AND II
VIRGINIA MILITARY SURVEYS
9925, 9946 AND 10121
WASHINGTON TOWNSHIP
LOGAN COUNTY, OHIO

INDIAN MOUND PARK

BOAT WELL
ON STILTS

WOOD BOAT
DOCK

SURVEYED BY:

William K. Bruce

WILLIAM K. BRUCE
PROFESSIONAL SURVEYOR 7437
JANUARY 10, 2008

COPYRIGHT 2008 BY:
LEE SURVEYING & MAPPING CO., INC.
117 North Madriver Street
BELLEFONTAINE, OHIO 43311
(937) 593-7335
surveys@lsminc.us
KSS D0108 4572018 L-4572-3



ORIGINAL STAMP IN GREEN

INDEXED ON MAP
5926 IP

2 WORKING DAYS
BEFORE YOU DIG
CALL TOLL FREE 800-362-2764
OHIO UTILITIES PROTECTION SERVICE.

3-12-25



APPROVED



**HOWBERT
SURVEYING**

LLC
8477 MERICLE ROAD
FORT JENNINGS, OHIO 45844
419-863-0289

**Description
For
0.012 Acre**

- Situated in the Virginia Military Survey 9925, 9946 and 10121, Washington Township, Logan County, Ohio, being part of the State of Ohio Indian Lake Reservoir Lands and being more particularly described as follows;
- Commencing at the northwest corner of Lot 209 of Moundwood Allotment (Plat Cabinet A, Slide 231), being a 5/8" iron pin found;
- Thence with the westerly line of Moundwood Allotment, S.05°50'13"E., a distance of 823.41 feet to the Principal Point of Beginning, passing a 5/8" iron pin found at 718.21 feet and a 5/8" iron pin set at 820.41 feet;
- Thence along the extension of said westerly line, S.05°50'13"E., a distance of 7.49 feet to a point
- Thence along said a sea wall on the following three (3) courses and distances:
1. N.66°50'23"W., a distance of 42.67 feet to a point;
 2. S.24°09'33"W., a distance of 4.81 feet to a point;
 3. N.65°31'52"W., a distance of 55.50 feet to a point;
- Thence on the extension of the west line of a 0.137 acre tract conveyed to Contance M. and Lawrence J. Little as described in Official Record Volume 1377, Page 274, N.31°36'06"E., a distance of 2.56 feet to a cross notch set in a concrete seawall;
- Thence along the south line of said tract, S.71°25'38"E., a distance of 94.54 feet to the **Principal Point of Beginning**;
- Containing 0.012 acre, more or less, and being subject to all legal highways, rights-of-way, easements, restrictions, covenants, and/or conditions of record.

The above description based on a survey prepared by Michael L. Howbert, Registered Professional Surveyor No. 7959, March 3, 2025. The basis of bearings is based on Ohio North State Plane Grid, NAD 83, Adjustment 2011.

Michael L. Howbert, P.S.



INDEXED ON MAP

5926

3-12-25



APPROVED

PLAT OF SURVEY FOR LITTLE

SITUATED IN:
STATE OF OHIO
INDIAN LAKE RESERVOIR LANDS
VIRGINIA MILITARY SURVEYS 9925, 9946,
AND 10121
WASHINGTON TOWNSHIP,
LOGAN COUNTY, OHIO

NORTH AND BEARING
SYSTEM BASED ON
OHIO NORTH STATE
PLANE GRID, NAD 83
ADJ. 2011.

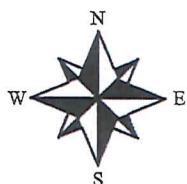

HAROLD M. HAMILTON, ET.UX.
O.R. 63, PG. 440
0.11 AC. TRACT ONE

CONSTANCE M. AND
LAWRENCE J. LITTLE
O.R. 1377, PG. 274
0.137 AC.

0.012 ACRE

INDIAN LAKE

LEGEND:

- 5/8" IRON PIN FOUND
- ⊙ 7/8" IRON PIN FOUND
- 5/8" IRON PIN W/ CAP SET
- ✕ CROSS NOTCH SET

NOTES:

FOUND MONUMENTATION IN GOOD CONDITION
UNLESS OTHERWISE NOTED.
DATA SOURCES INCLUDE DOCUMENTS CITED.
5926 1P BRUCE #7437 DATED JANUARY 10, 2008
A TITLE SEARCH IS RECOMMENDED TO DETERMINE
EASEMENTS, RESTRICTIONS, AND/OR OTHER
ENCUMBRANCES AFFECTING THE PROPERTY
SHOWN HEREON.



**HOWBERT
SURVEYING
LLC**

8477 MERICLE ROAD
FORT JENNINGS, OHIO 45844
419-863-0289

DATE: 3/3/25

REV.:

CLIENT: C. LITTLE

SCALE: 1" = 20'

JOB #: 4011-01-25

CHK:

THIS PLAT IS BASED ON AN ACTUAL FIELD SURVEY.

MICHAEL L. HOWBERT
REGISTERED PROFESSIONAL
SURVEYOR NO. 7959 IN OHIO
MARCH 3, 2025

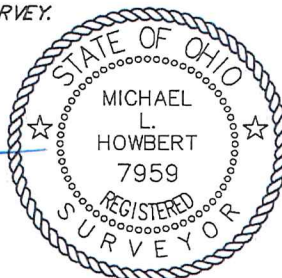

INDEXED ON MAP
5926

