

**LOGAN COUNTY**  
**CO. RD.-2 - CO. RD.-142**  
**T. RD.-31 ~ T. RD.-37**

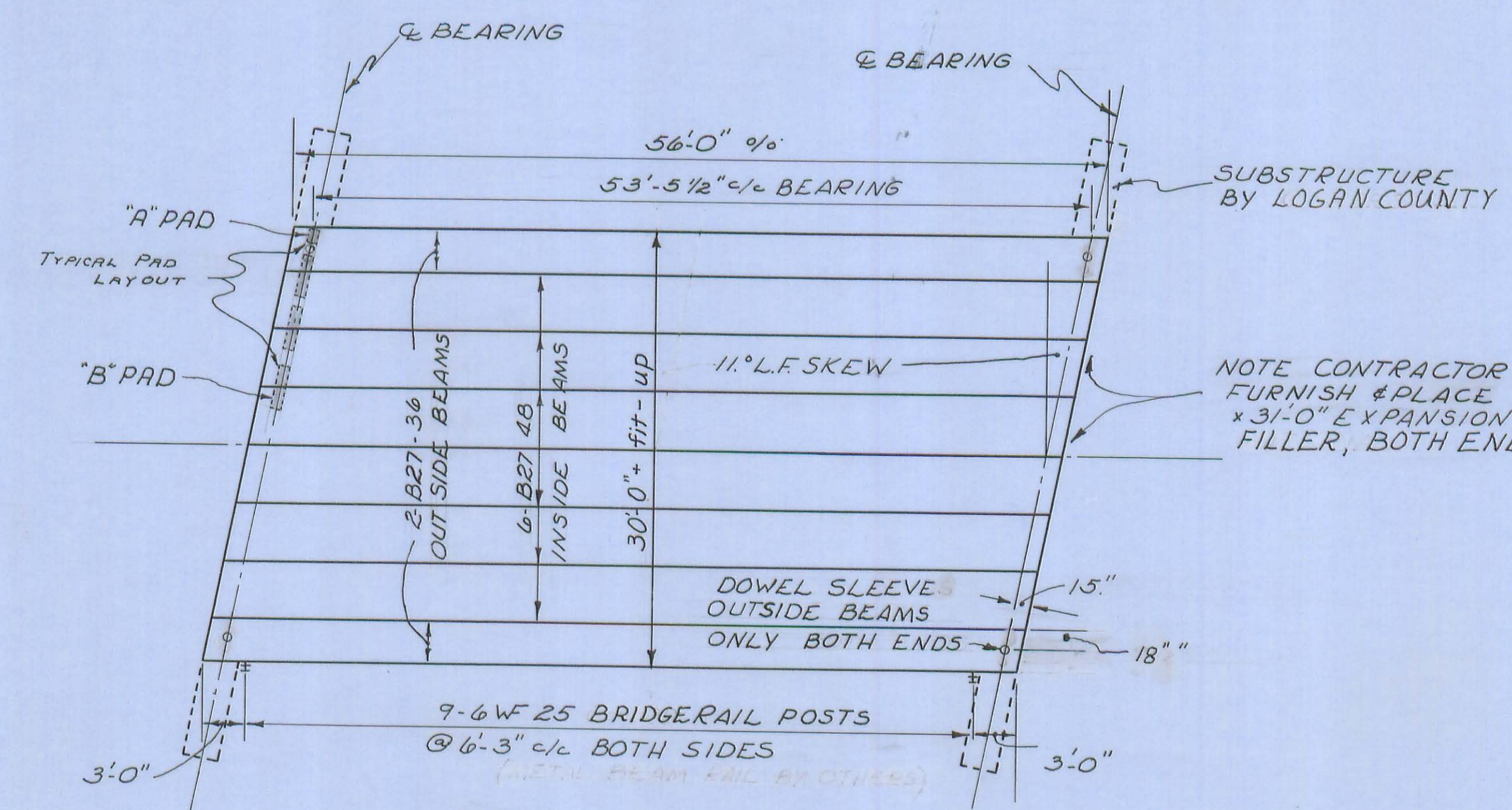

SCHEMATIC PLAN  
 Scale 1/8" = 1'-0"

NOTE CONTRACTOR SHALL FURNISH & PLACE 1" x 2" x 3'-0" EXPANSION JOINT FILLER, BOTH ENDS

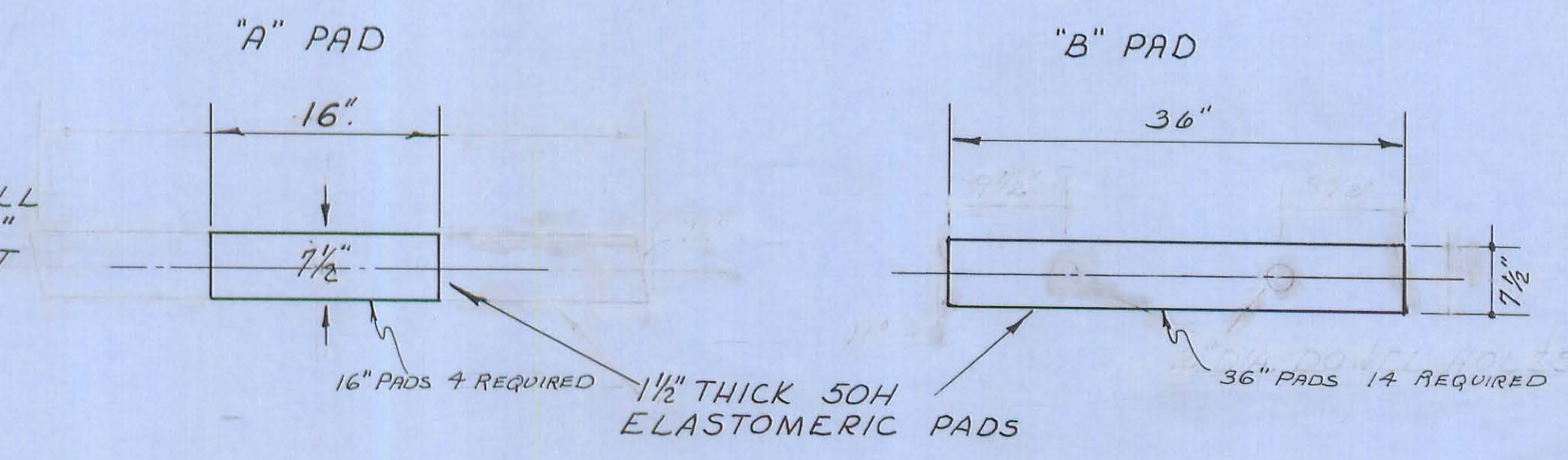

BEARING PAD DETAIL  
 Scale 1" = 1'-0"

NOTE: 9 shims, 1/8" thick, as per 711.21 shall be provided. They shall be the same plan dimension as the bearing pads, and included with the bearing pads for payment.

NOTE: BEAMS SHALL HAVE 2 - THREE FOOT DIAPHRAGMS LOCATED AT APPROXIMATE THIRD POINTS, SO THAT TIE-RODS DO NOT INTERFERE WITH BRIDGE RAIL POSTS. DIAPHRAGMS SHALL BE DESIGNED ACCORDING TO PSBD-1-71 PAGE 2 FOR 48" BEAMS @ BETWEEN 4° AND 14°.

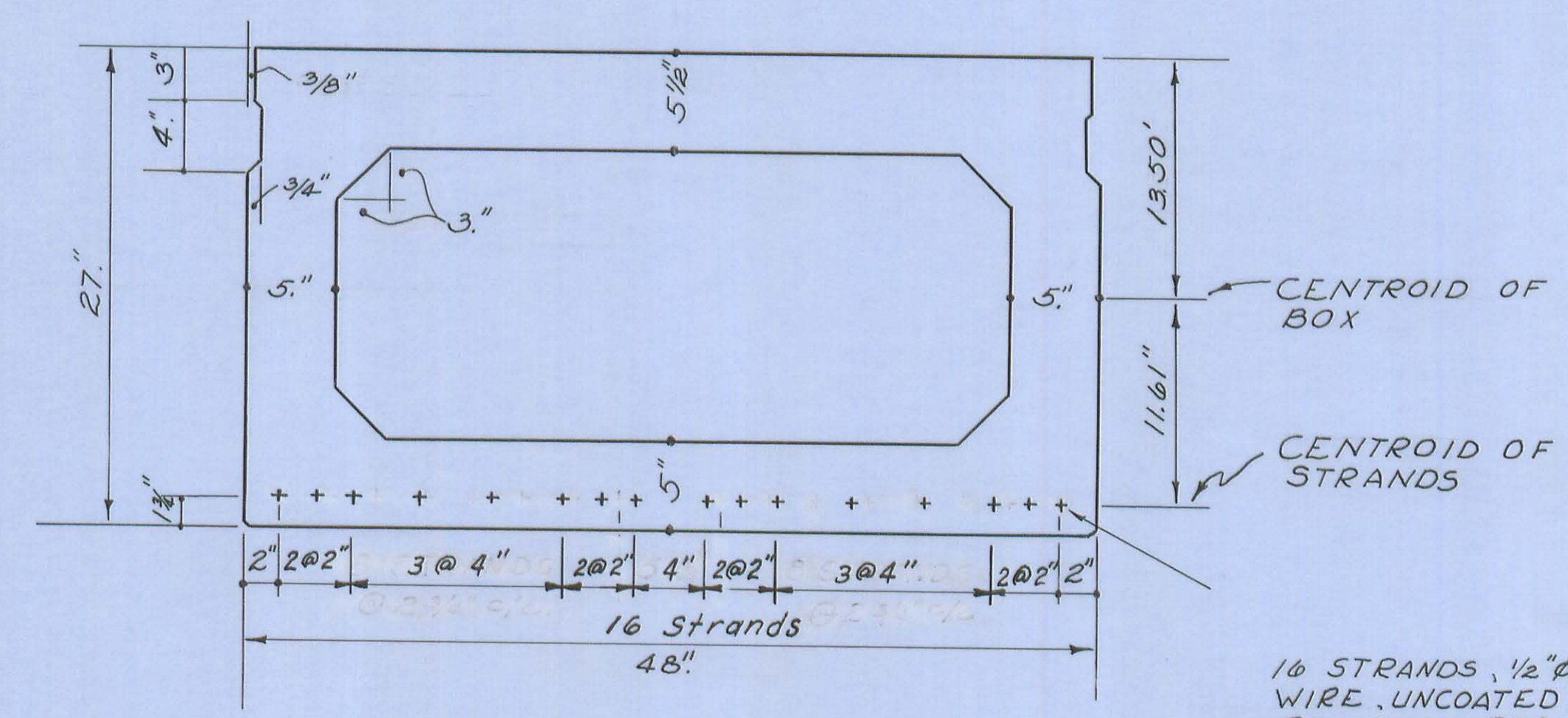

TYPICAL B27-48 56'-0" 0/0  
 STRAND LOCATION  
 Scale 1 1/2" = 1'-0"

16 STRANDS, 1/2" φ, 270<sup>k</sup>, SEVEN WIRE UNCOATED, STRESS RELIEVED STRAND. INITIAL TENSION = 28,900 #/STRAND NO DEBONDED STRANDS ADDITIONAL TOP BARS EACH END 5 - NO. 5 - 6'-6" INITIAL CAMBER = .45"

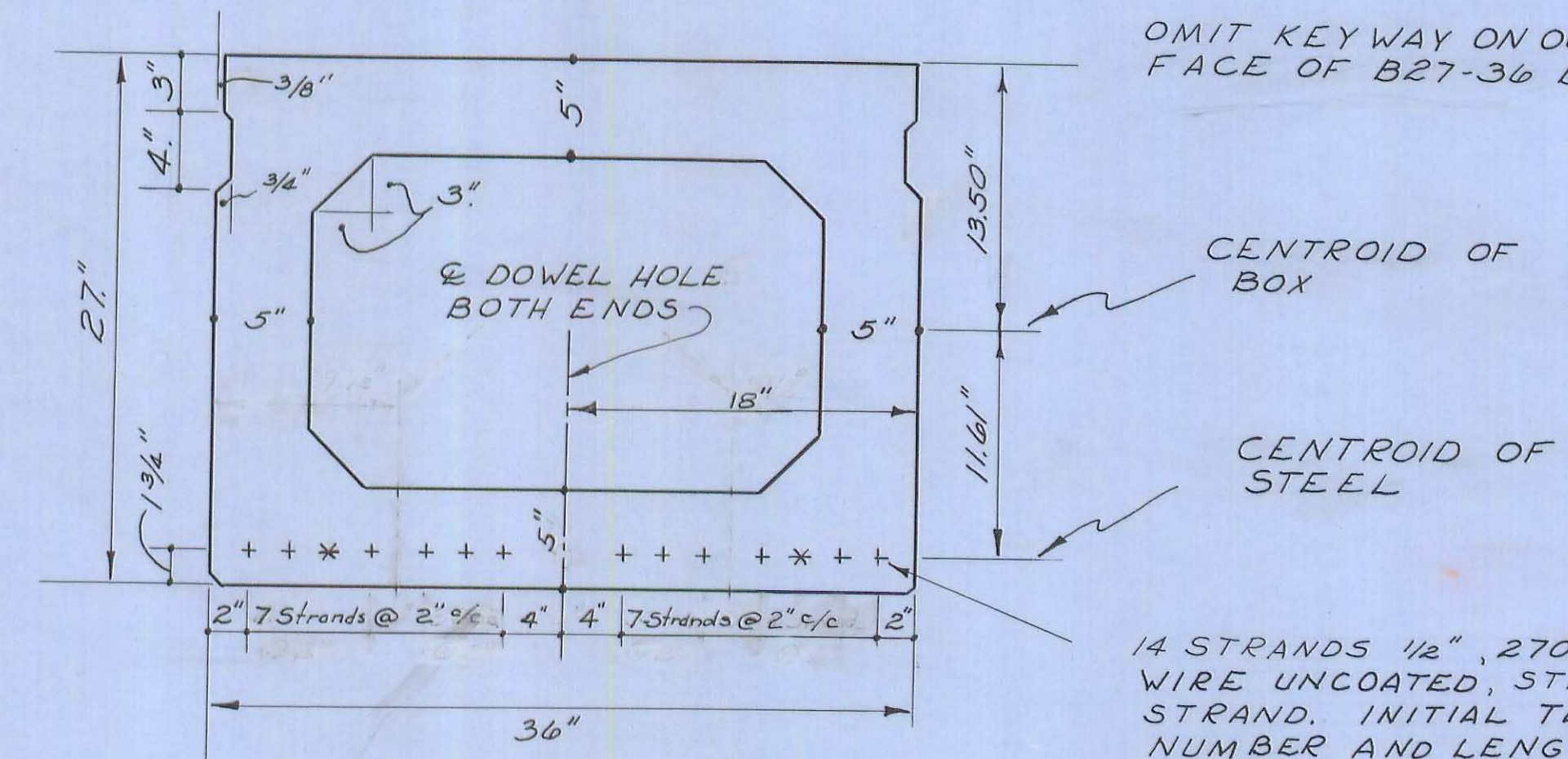

TYPICAL B27-36 56'-0" 0/0  
 STRAND LOCATION  
 Scale 1 1/2" = 1'-0"

14 STRANDS 1/2", 270<sup>k</sup>, SEVEN WIRE UNCOATED, STRESS RELIEVED STRAND. INITIAL TENSION = 28,900 #/STRAND NUMBER AND LENGTH DEBONDED \* 2 @ 1'-6" (LENGTH MEASURED FROM BEAM END) ADDITIONAL TOP BARS EACH END 4 - NO. 5 - 8'-6" LONG INITIAL CAMBER .58"

REINFORCING: The clearance to the stirrups, in the top of the box, shown as 1" on PSBD-1-71, shall be 2". This may require the bending diagrams for the stirrups to be revised from what is shown on the standard.

OMIT KEYWAY ON OUTSIDE FACE OF B27-36 BEAMS.

LOGAN COUNTY ENGINEER  
 CHESTER R. KURTZ

PRESTRESSED BEAM DETAILS  
 LOGAN COUNTY, OHIO  
 BRIDGE NO. 142-761

|        |       |         |          |
|--------|-------|---------|----------|
| Design | Drawn | Checked | Approved |
| M.W.B. | C.N.  | D.L.D.  |          |