

LOCATION MAP

LATITUDE: 40°21'04" N LONGITUDE: 83°56'19" W

UTILITY OWNERS	
TYPE	NAME & ADDRESS
ELECTRIC:	DAYTON POWER & LIGHT COMPANY 1900 DRYDEN ROAD DAYTON, OHIO 45439 937-331-4132 ATTN: JOHN KENTON
ELECTRIC:	LOGAN COUNTY CO-OP 1587 CR 32, NORTH PO BOX 279 BELLEFONTAINE, OHIO 43311 937-592-4781 ATTN: DAVE YANCHIK
TELEPHONE:	CENTURY LINK 127 N. MAIN ST. BELLEFONTAINE, OHIO 43311 937-599-9285 ATTN: AL HOCKLEY

NOTES: THE LOCATION OF THE UNDERGROUND UTILITIES SHOWN ON THE PLANS ARE OBTAINED FROM THE OWNER OF THE UTILITIES AS REQUIRED BY SECTION 153.64 O.R.C.

CONVENTIONAL SYMBOLS

County Line	-----	Ditch / Creek (Ex)	-----
Township Line	-----	Ditch / Creek (Pr)	-----
Section Line	-----	Tree Line (Ex)	~~~~~
Corporation Line	----- or -----	Ownership Hook Symbol	∟, Example ∟
Fence Line (Ex)	-----	Property Line Symbol	ℙ, Example ℙ
Center Line	-----	Break Line Symbol	∟, Example ∟
Right of Way (Ex)	----- Ex R/W	Tree (Pr)	☼, Tree (Ex) ☼, Shrub (Ex) ☼
Right of Way (Pr)	----- R/W	Tree (Remove)	☼, Shrub (Remove) ☼
Standard Highway Ease.(Ex)	----- Ex SH	Evergreen (Ex)	☼, Stump ☼
Temporary Right of Way	----- TMP	Evergreen (Remove)	☼, Stump (Remove) ☼
Channel Ease. (Pr)	----- CH	Wetland (Pr)	∩, Grass (Pr) ∩, Aerial Target ∩
Utility Ease. (Ex)	----- Ex U	Post (Ex)	○, Mailbox (Ex) □, Mailbox (Pr) □
Railroad	----- or -----	Light (Ex)	☼, Telephone Marker (Ex) TEL
Guardrail (Ex)	----- (Pr)	Fire Hydrant (Ex)	☼, Water Meter (Ex) ☼
Construction Limits	-----	Water Valve (Ex)	☼, Utility Valve Unknown (Ex.) ☼
Edge of Pavement (Ex)	-----	Telephone Pole (Ex)	☼, Power Pole (Ex) ☼
Edge of Pavement (Pr)	-----	Light Pole (Ex)	☼
Edge of Shoulder (Ex)	-----		
Edge of Shoulder (Pr)	-----		

RIGHT OF WAY LEGEND SHEET

LOG-21-1.00

LOGAN COUNTY
PLEASANT TOWNSHIP
SECTION 15, TOWN 2-RANGE 14
SECTION 1, TOWN 1-RANGE 8

INDEX OF SHEETS:

LEGEND SHEET	1
CENTERLINE PLAT	2
PROPERTY MAP	3
SUMMARY OF ADDITIONAL R/W	4
R/W DETAIL	5

PROJECT DESCRIPTION

REHABILITATION OF A THROUGH TRUSS BRIDGE OVER THE GREAT MIAMI RIVER INCLUDING DISASSEMBLY, GALVAIZING, AND REERECTION WITH A NEW DECK AND WEARING SURFACE WITH RECONSTRUCTION OF THE APPROACH ROADWAY.

THE EXISTING AND PROPOSED RIGHT OF WAY SHALL BE REFERENCED FROM THE CENTERLINE OF RIGHT OF WAY.

PLANS PREPARED BY:

FIRM NAME : KOHLI & KALHER ASSOC., INC.
R/W DESIGNER: BECKY SWORA, P.E.
R/W REVIEWER: MICHAEL G. BUETTNER, P.S.
FIELD REVIEWER: MICHAEL G. BUETTNER, P.S.
PRELIMINARY FIELD REVIEW DATE: 6/14/2013
TRACINGS FIELD REVIEW DATE:
OWNERSHIP UPDATED BY:
DATE COMPLETED:
PLAN COMPLETION DATE:

TYPES OF TITLE LEGEND:
SH = STANDARD HIGHWAY EASEMENT
T = TEMPORARY EASEMENT

I, Michael G. Buettner, P. S. have conducted a survey of the existing conditions for the Logan County Engineer through June 14th, 2013. The results of that survey are contained herein. The horizontal coordinates expressed herein are based on the Ohio State Plane Coordinates System North Zone on NAD 83 (CORS96) datum. The Project Coordinates (US Survey Feet) are relative to State Plane Grid Coordinates (US Survey Feet) by a Project Adjustment Factor of 1.00000000. As a part of this project I have reestablished the locations of the existing property lines and the existing centerline of Right of Way for property takes contained herein. As a part of this project I have established the proposed property lines, calculated the Gross Take, present roadway occupied (PRO), Net Take and Net Residue; as well as prepared the legal descriptions necessary to acquire the parcels as shown herein. All of my work contained herein was conducted in accordance with Ohio Administrative Code 4733-37 commonly known as "Minimum Standards for Boundary Surveys in the State of Ohio" unless noted. The words I and my as used herein are to mean either myself or someone working under my direct supervision.

Michael G. Buettner
Michael G. Buettner, Professional Land Surveyor No. 6881

Date: October 31, 2013

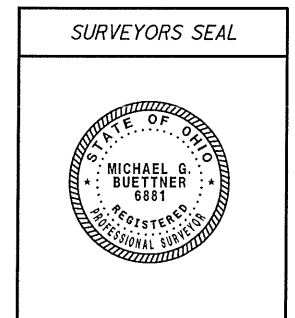

I:\PROJECTS\LOG-87081\row\sheet\87081RL001.dgn 10/31/2013 8:51:15 AM B

FEDERAL PROJECT NO. E110(333)
PID NO. 87081
CALCULATED BS MGB
RIGHT OF WAY LEGEND SHEET
LOG-CR 21-1.00
1/5

I, Michael G. Buettner, P. S. have conducted a survey of the existing conditions for the Logan County Engineer through June 14th, 2013. The results of that survey are contained herein. The horizontal coordinates expressed herein are based on the Ohio State Plane Coordinates System NAD 83, North Zone using CORS96 adjustment, by ties to the ODOT CORS network using ODOT's VRS network. The Project Adjustment Factor used for this project is 1.00000000. As a part of this project I have reestablished the locations of the existing property lines and centerline of existing Right of Way for property takes contained herein. All of my work contained herein was conducted in accordance with Ohio Administrative Code 4733-37 commonly known as "A Minimum Standards for Boundary Surveys in the State of Ohio" unless noted. The words I and my as used herein are to mean either myself or someone working under my direct supervision.

Michael G. Buettner

Michael G. Buettner, Professional Land Surveyor No. 6881

Date: October 31, 2013

**SECTION 1, TOWN 1-RANGE 8
"CONGRESS LANDS WEST OF MIAMI RIVER"
PLEASANT TOWNSHIP
LOGAN COUNTY**

**SECTION 15, TOWN 2-RANGE 14
"BETWEEN THE MIAMIS" SURVEY
PLEASANT TOWNSHIP
LOGAN COUNTY**

MONUMENT LEGEND

- ▣ PROPOSED R/W MONUMENT BOX
- ⊕ T.B.F. TBAR WITH "KK" CAP
- M.N.F. EXISTING MAGNAIL
- I.P.F. IRON PIN FOUND
- M.N.S. MAGNAIL SET

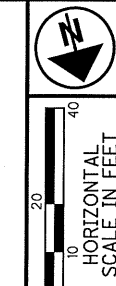

PID NO. **87081**

R/W DESIGNER BS
R/W REVIEWER MGB

CENTERLINE PLAT

LOG-CR 21-1.00

2 / 5

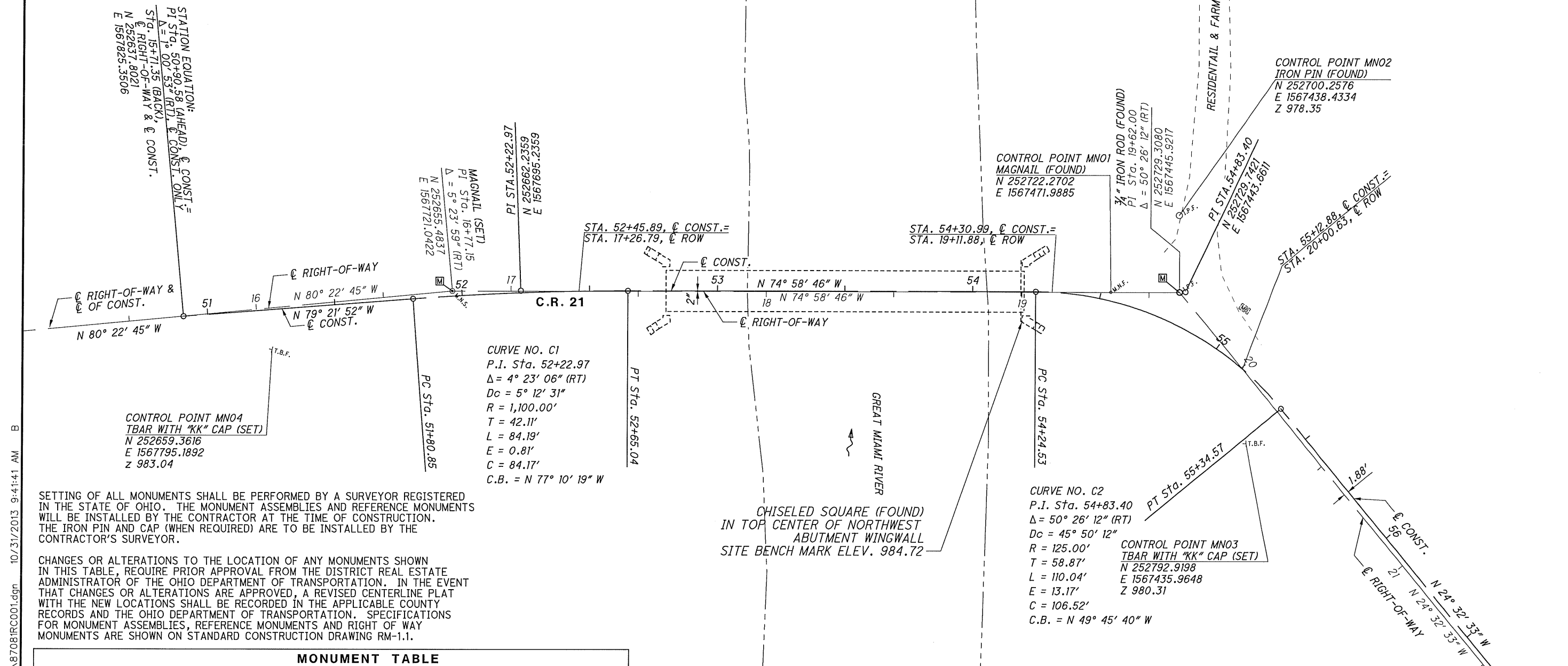

SETTING OF ALL MONUMENTS SHALL BE PERFORMED BY A SURVEYOR REGISTERED IN THE STATE OF OHIO. THE MONUMENT ASSEMBLIES AND REFERENCE MONUMENTS WILL BE INSTALLED BY THE CONTRACTOR AT THE TIME OF CONSTRUCTION. THE IRON PIN AND CAP (WHEN REQUIRED) ARE TO BE INSTALLED BY THE CONTRACTOR'S SURVEYOR.

CHANGES OR ALTERATIONS TO THE LOCATION OF ANY MONUMENTS SHOWN IN THIS TABLE, REQUIRE PRIOR APPROVAL FROM THE DISTRICT REAL ESTATE ADMINISTRATOR OF THE OHIO DEPARTMENT OF TRANSPORTATION. IN THE EVENT THAT CHANGES OR ALTERATIONS ARE APPROVED, A REVISED CENTERLINE PLAT WITH THE NEW LOCATIONS SHALL BE RECORDED IN THE APPLICABLE COUNTY RECORDS AND THE OHIO DEPARTMENT OF TRANSPORTATION. SPECIFICATIONS FOR MONUMENT ASSEMBLIES, REFERENCE MONUMENTS AND RIGHT OF WAY MONUMENTS ARE SHOWN ON STANDARD CONSTRUCTION DRAWING RM-1.1.

MONUMENT TABLE

☐ of C.R. 21		PROJECT COORDINATES SEE SURVEY CERTIFICATION		MONUMENTS TO BE SET DURING CONSTRUCTION		DESCRIPTION
STATION	OFFSET	NORTH (Y)	EAST (X)	MON. ASSY.	REF. MON.	
16+77.15	☐	252655.4837	1567721.0422	1		P.I. - ☐ OF R/W
19+62.00	☐	252729.3080	1567445.9217	1		P.I. - ☐ OF R/W
TOTAL CARRIED TO GENERAL SUMMARY SHEET				2		

BASIS FOR BEARINGS:

Bearings are based on the grid of the North Zone of the Ohio State Plane Coordinate System.

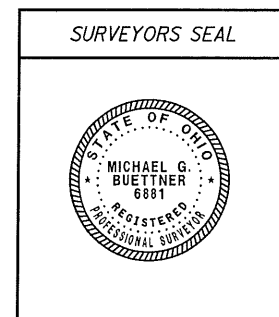

RECEIVED _____, 20____
RECORDED _____, 20____
BOOK _____ PAGE _____
COUNTY RECORDER

I:\PROJECTS\LOG\87081\row\sheet\87081RC001.dgn 10/31/2013 9:41:41 AM B

SECTION 1, TOWN 1-RANGE 8
 "CONGRESS LANDS WEST OF
 MIAMI RIVER"
 PLEASANT TOWNSHIP
 LOGAN COUNTY

SECTION 15, TOWN 2-RANGE 14
 "BETWEEN THE MIAMIS" SURVEY
 PLEASANT TOWNSHIP
 LOGAN COUNTY

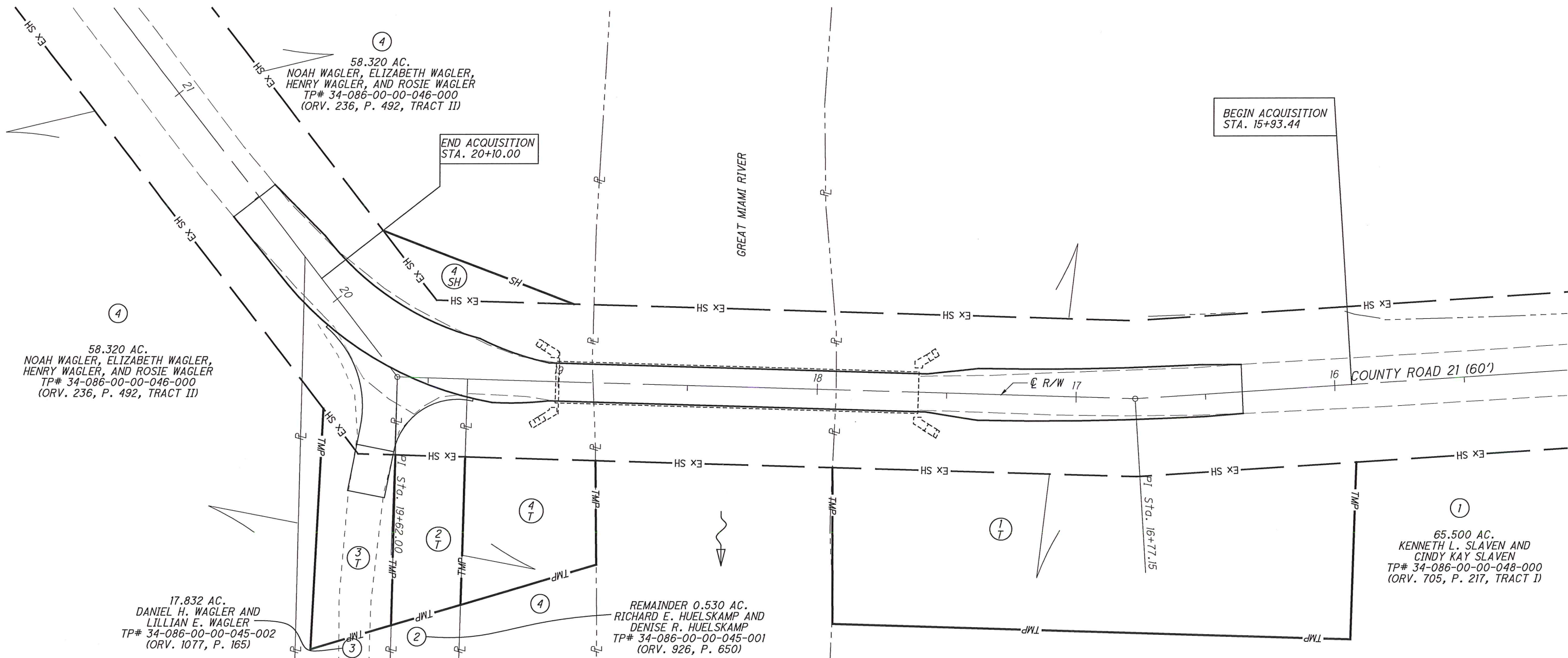
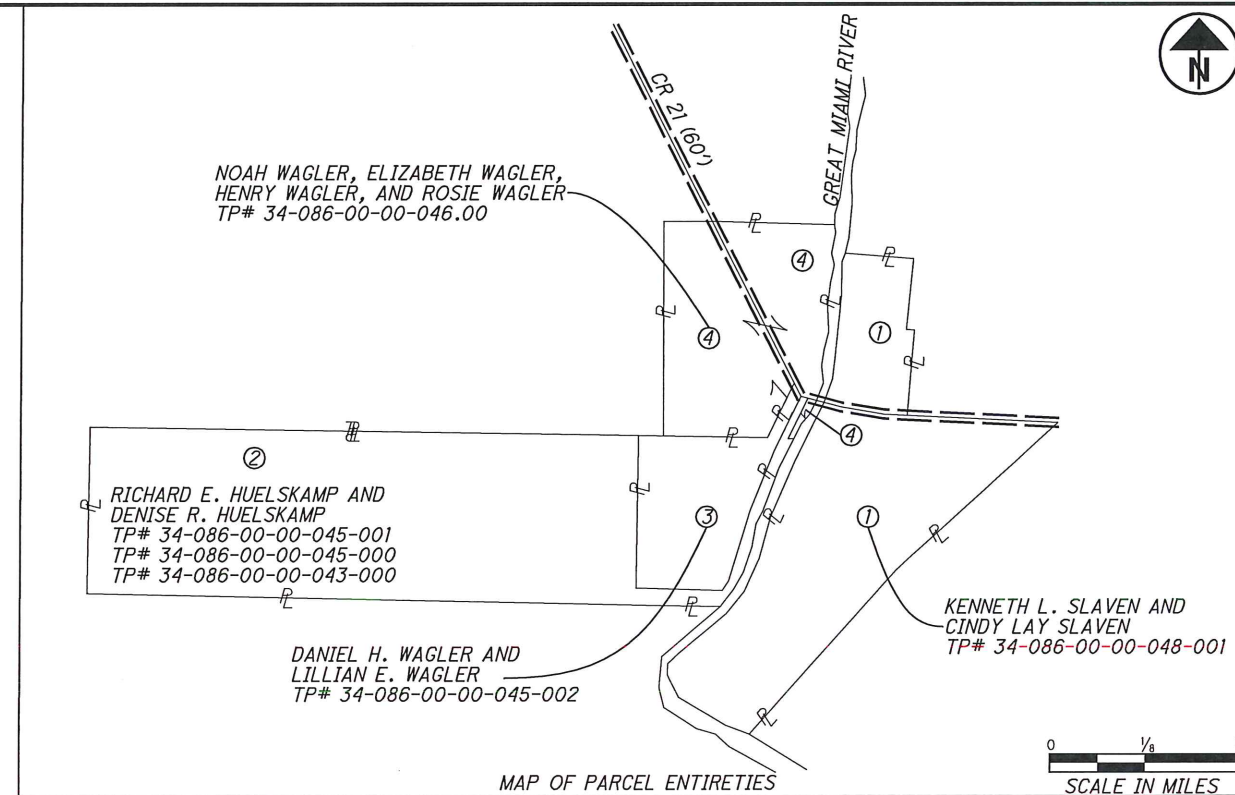

PID NO.
87081

R/W DESIGNER
 BS
 R/W REVIEWER
 MGB

PROPERTY MAP

LOG-CR 21-1.00

3 / 5



TOTAL NUMBER OF :

4 OWNERSHIPS 0 TOTAL TAKES
 4 PARCELS 0 OWNERSHIPS W/ STRUCTURES INVOLVED

NET RESIDUE = RECORD AREA - TOTAL PRO - NET TAKE

GRANTEE:

ALL RIGHT OF WAY ACQUIRED IN THE NAME OF
 THE BOARD OF COUNTY COMMISSIONERS OF LOGAN COUNTY, OHIO
 UNLESS OTHERWISE SHOWN.

ALL AREAS IN ACRES

PARCEL NO.	OWNER	SHEET NO.	OWNERS RECORD	AUDITOR'S PARCEL	RECORD AREA	TOTAL P.R.O.	GROSS TAKE	P.R.O. IN TAKE	NET TAKE	STRUC-TURE	NET RESIDUE		TYPE FUND	REMARKS	AS ACQUIRED	
											LEFT	RIGHT			BOOK	PAGE
1T	KENNETH L. SLAVEN AND CINDY KAY SLAVEN	5	ORV. 705, P. 217, TRACT I	34-086-00-00-048-001	73.240 #(65.5)	1.722	0.285	0	0.285	NO				TEMPORARY EASEMENT TO REHABILITATE THE EXISTING HISTORIC BRIDGE NOTE: 73.240 ACRES IS AREA CARRIED ON AUDITOR'S DUPLICATE #(NOTE: TAKE AREA IS PART OF 65.5 ACRE TRACT DESCRIBED AT ORV. 705, P. 217, TRACT I)		
2T	RICHARD E. HUELSKAMP AND DENISE R. HUELSKAMP	5	ORV. 926, P. 650	34-086-00-00-045-001	0.216 #(0.53)	0.019	0.037	0	0.037	NO				TEMPORARY EASEMENT TO REHABILITATE THE EXISTING HISTORIC BRIDGE NOTE: 0.216 ACRES IS AREA CARRIED ON AUDITOR'S DUPLICATE #(NOTE: TAKE IN AREA IS PART OF 0.53 ACRE TRACT DESCRIBED AT ORV. 926, P. 650)		
				34-086-00-00-045-000	0.701	0	-	-	-					CONTIGUOUS PARCEL, SAME OWNER		
				34-086-00-00-043-000	87.119	0	-	-	-					CONTIGUOUS PARCEL, SAME OWNER		
3T	DANIEL H. WAGLER AND LILLIAN E. WAGLER	5	ORV. 1077, P. 165	37-086-00-00-045-002	17.832	0.037	0.051	0	0.051	NO				TEMPORARY EASEMENT TO REHABILITATE THE EXISTING HISTORIC BRIDGE		
4SH	NOAH WAGLER, ELIZABETH WAGLER, HENRY WAGLER, AND ROSIE WAGLER	5	ORV. 236, P. 492, TRACT II	34-086-00-00-046-000	40.320 #(58.32)	1.200	0.085	0.069	0.016	NO	24.704	14.400		NOTE: 40.320 ACRES IS AREA CARRIED ON AUDITOR'S DUPLICATE #(NOTE: TAKE AREA IS PART OF 58.32 ACRE TRACT DESCRIBED AT ORV. 236, P. 492, TRACT II)		
4T		5					0.057	0	0.057	NO				TEMPORARY EASEMENT TO REHABILITATE THE EXISTING HISTORIC BRIDGE		

TYPES OF TITLE LEGEND:
 SH = STANDARD HIGHWAY EASEMENT
 T = TEMPORARY EASEMENT

NOTE: ALL TEMPORARY PARCELS TO BE OF 12 MONTH DURATION.

REV. BY	DATE	DESCRIPTION

FEDERAL PROJECT NO. E110(333)
 PID NO. 87081
 STATE JOB NO.
 R/W DESIGNER BS
 R/W REVIEWER MGB
SUMMARY OF ADDITIONAL RIGHT OF WAY
 LOG-CR 21-1.00
 4 / 5

I:\PROJECTS\LOG\87081\row\sheet\87081RS001.dgn 10/31/2013 8:51:27 AM B

SECTION 1, TOWN 1-RANGE 8
 "CONGRESS LANDS WEST OF MIAMI RIVER"
 PLEASANT TOWNSHIP
 LOGAN COUNTY

SECTION 15, TOWN 2-RANGE 14
 "BETWEEN THE MIAMIS" SURVEY
 PLEASANT TOWNSHIP
 LOGAN COUNTY

MONUMENT LEGEND

- ☐ PROPOSED R/W MONUMENT BOX
- I.P.S. 3/4 INCH DIAMETER IRON PIPE (SET THIS SURVEY WITH ORANGE "K&K/LIMA" PLUG)
- ⊕ T.B.F. T.BAR WITH "KK" CAP
- M.M.F. EXISTING MAGNAIL
- I.P.F. IRON PIN FOUND
- M.N.S. MAGNAIL SET

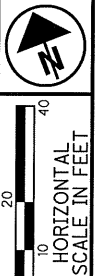

PID NO. 87081

R/W DESIGNER BS
 R/W REVIEWER MGB

RIGHT OF WAY PLAN

LOG-CR 21-1.00

5 / 5

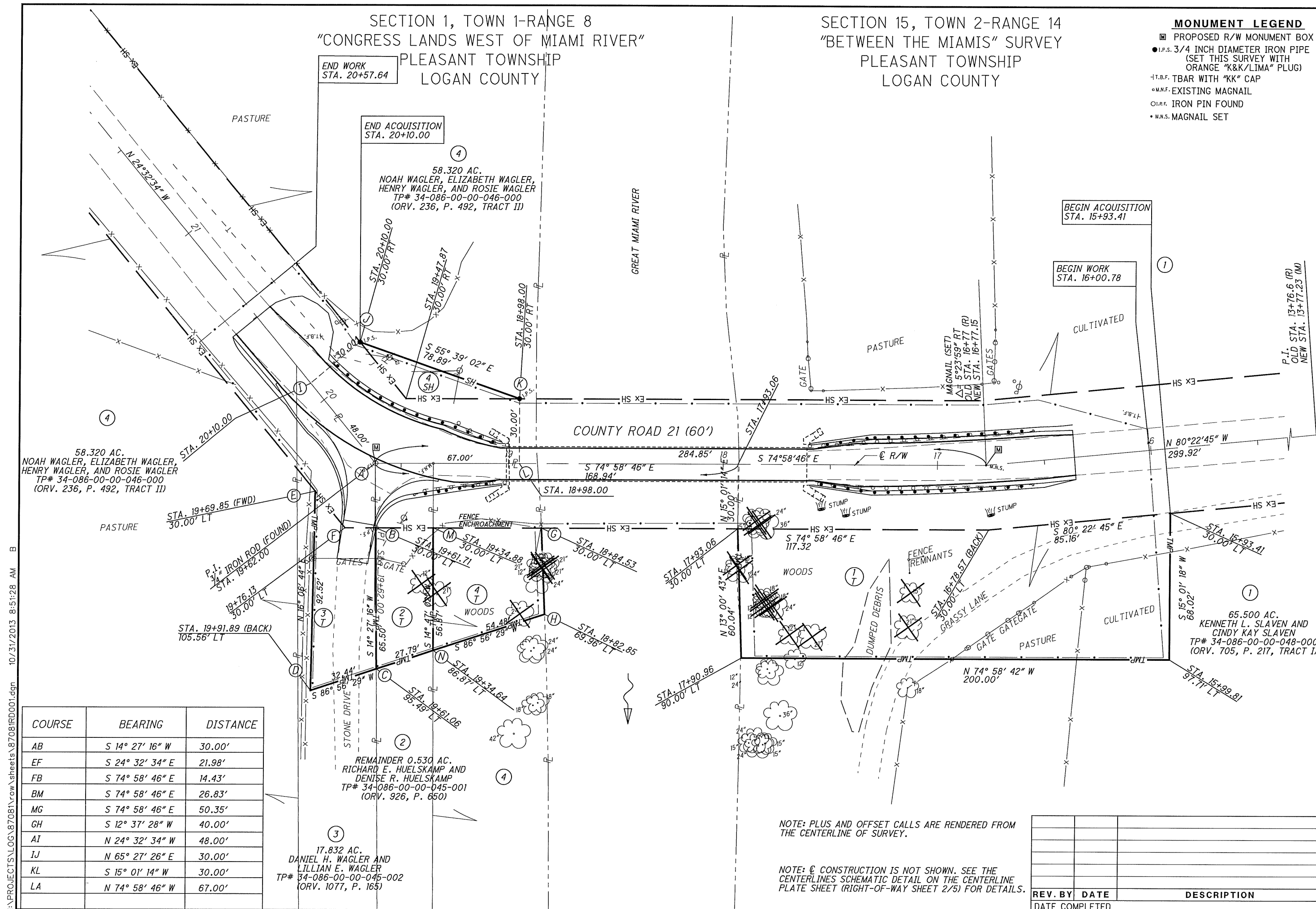

58.320 AC.
 NOAH WAGLER, ELIZABETH WAGLER,
 HENRY WAGLER, AND ROSIE WAGLER
 TP# 34-086-00-00-046-000
 (ORV. 236, P. 492, TRACT II)

58.320 AC.
 NOAH WAGLER, ELIZABETH WAGLER,
 HENRY WAGLER, AND ROSIE WAGLER
 TP# 34-086-00-00-046-000
 (ORV. 236, P. 492, TRACT II)

REMAINDER 0.530 AC.
 RICHARD E. HUELSKAMP AND
 DENISE R. HUELSKAMP
 TP# 34-086-00-00-045-001
 (ORV. 926, P. 650)

17.832 AC.
 DANIEL H. WAGLER AND
 LILLIAN E. WAGLER
 TP# 34-086-00-00-045-002
 (ORV. 1077, P. 165)

65.500 AC.
 KENNETH L. SLAVEN AND
 CINDY KAY SLAVEN
 TP# 34-086-00-00-048-000
 (ORV. 705, P. 217, TRACT I)

COURSE	BEARING	DISTANCE
AB	S 14° 27' 16" W	30.00'
EF	S 24° 32' 34" E	21.98'
FB	S 74° 58' 46" E	14.43'
BM	S 74° 58' 46" E	26.83'
MG	S 74° 58' 46" E	50.35'
GH	S 12° 37' 28" W	40.00'
AI	N 24° 32' 34" W	48.00'
IJ	N 65° 27' 26" E	30.00'
KL	S 15° 01' 14" W	30.00'
LA	N 74° 58' 46" W	67.00'

NOTE: PLUS AND OFFSET CALLS ARE RENDERED FROM THE CENTERLINE OF SURVEY.

NOTE: ☉ CONSTRUCTION IS NOT SHOWN. SEE THE CENTERLINES SCHEMATIC DETAIL ON THE CENTERLINE PLATE SHEET (RIGHT-OF-WAY SHEET 2/5) FOR DETAILS.

REV. BY	DATE	DESCRIPTION

I:\PROJECTS\LOG\87081\row\87081RD001.dgn 10/31/2013 8:51:28 AM B